

ALUMINUM COMPATIBLE LASER WELDABLE 50 OHM FEEDTHROUGH SSMA ADAPTABLE, .012 OR .015 DIAMETER CENTER CONTACT

REVISIONS			
REV	CHANGE NO.	DATE	CFG APPROVAL
-	INIT RLSE	2008-09-29	J. PETRI
A	DCN000638	4/22/2010	J. PETRI
B	DCN000844	6/10/2011	

- CONFIGURATION FOR INTERFACING TO PANEL JACK ADAPTER (SRI CONNECTOR GAGE PART NUMBER 13-150-1500-00, INSTALL AT 13±1 LB-IN)
- DESIGNED TO LASER WELD INTO AN ELECTRONIC CHASSIS
- INDUSTRY STANDARD NICKEL-IRON-COBALT ALLOY CONTACT WITH CORNING 7070 EQUIVALENT GLASS
- INTEGRAL RF GROUNDING TAB FOR EXCELLENT PERFORMANCE OVER TEMPERATURE

1. LEAK RATE: LESS THAN OR EQUAL TO 1X10E-9 CC/SEC He AT ONE ATMOSPHERE DIFFERENTIAL PRESSURE.
2. NOMINAL IMPEDANCE: 50 OHMS
3. INTERFACE IN ACCORDANCE WITH MIL-STD-348, SSMA.

4. MATERIALS:
 PIN: NICKEL-IRON-COBALT ALLOY IN ACCORDANCE WITH ASTM F15.
 DIELECTRIC: CORNING 7070 EQUIVALENT GLASS (LOW LOSS, MATCHED SEAL).
 SHELL (WELD FLANGE): ALUMINUM ALLOY 4047 IN ACCORDANCE WITH AWS A.5.8.
 RF GROUNDING SPRING: BERYLLIUM-COPPER ALLOY 172/173 IN ACCORDANCE WITH ASTM B 194 (NICKEL/GOLD PLATE)

5. FINISH:
 EXCEPT WELD FLANGE: NICKEL PLATE PER QQ-N-290, CLASS 2, .000100/.000250 THICK
 GOLD PLATE PER ASTM B488-01, TYPE III, CODE A, .000050/.000100 THICK.

6. ORDERING INSTRUCTIONS:
 SPECIFY BASE NUMBER FOLLOWED BY DASH NUMBERS INDICATING PIN DIAMETER, D AND PIN LENGTH, L:

EXAMPLE: SRIFT502 - 015 - 045 - A

- A=GROUNDING SPRING FOR AIR DIELECTRIC
 T=GROUNDING SPRING FOR TEFLON DIELECTRIC
- PIN LENGTH, L=.045 (.035 MIN)
- PIN DIAMETER, D=.015 (.012 OR .015)
- BASE NUMBER

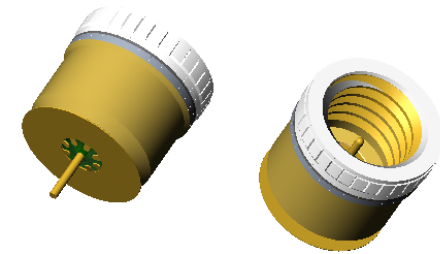

VIEWS FOR REFERENCE ONLY

- $\varnothing B \pm .001$ THRU (AIR DIELECTRIC)
- $\varnothing C \pm .001$ AS REQUIRED (TEFLON DIELECTRIC)
- $\varnothing .243 \pm .001$ $\nabla .230 \pm .002$
- $\varnothing .2580 \pm .0005$ $\nabla .100 \pm .005$

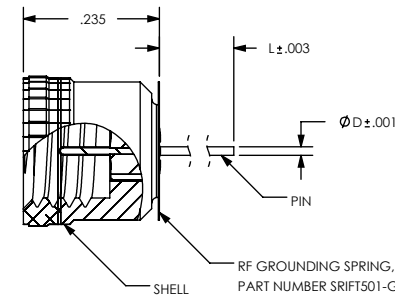
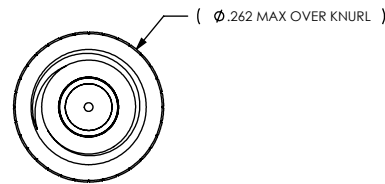
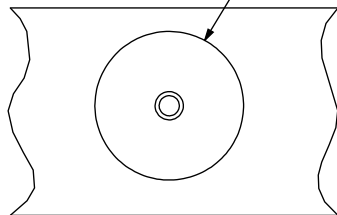

- RF GROUNDING SPRING, SHIPPED UNINSTALLED
- PART NUMBER SRIFT501-GS1, D=.012, AIR DIELECTRIC
- PART NUMBER SRIFT501-GS2, D=.015, AIR DIELECTRIC
- PART NUMBER SRIFT501-GS4, D=.012, TEFLON DIELECTRIC
- PART NUMBER SRIFT501-GS5, D=.015, TEFLON DIELECTRIC

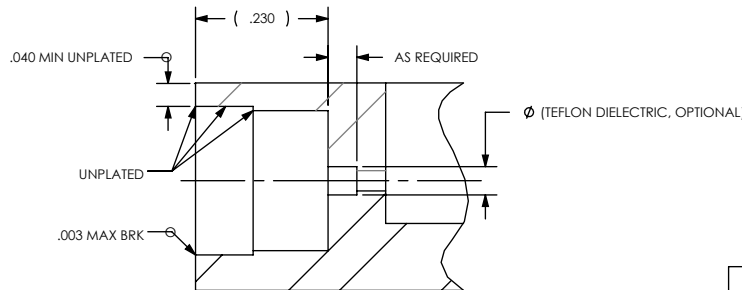

RECOMMENDED HOLE DETAIL

PART NUMBER	D	B	C
SRIFT502 - 012 - XXX - A	.012	.028	-----
SRIFT502 - 012 - XXX - T	.012	-----	.039
SRIFT502 - 015 - XXX - A	.015	.035	-----
SRIFT502 - 015 - XXX - T	.015	-----	.049

UNLESS OTHERWISE SPECIFIED		(321) 254-4067 WWW.SRIHERMETICS.COM	
DIMENSIONING IAW ASME Y14.5M-1994 DIMENSIONS APPLY AFTER PROCESSES DIMENSIONS IAW US CUSTOMARY UNITS .X ± .1, .XX ± .01, .XXX ± .005, $\angle \pm .5^\circ$.010 MAX OUTSIDE R, .005 MAX INSIDE R 125 RMS SURFACE FINISH		TITLE FEEDTHROUGH, THREADED SSMA, AC LBW	
THIRD ANGLE PROJECTION		SIZE A	DOCUMENT SRIFT502
		SCALE 3:1	SHEET 3PJY7 1 OF 1