

REVISIONS			
REV	CHANGE NO.	DATE	APPROVED
-	INIT RLSE	3/16/2010	J. PETRI

STAINLESS STEEL COMPATIBLE LASER WELDABLE SUB-D CONNECTOR

- TRADITIONAL CONFIGURATION WITH THE FLANGE LOCATED AT THE MIDSECTION OF THE CONNECTOR
- DESIGNED TO LASER WELD INTO AN ELECTRONIC CHASSIS WALL
- CONFORMS TO MIL-DTL-24308, ARRANGEMENT 2 PIN COUNTS 15, 26, 44, 62, 78 AND ARRANGEMENT 1 PIN COUNT 104 CONTACT CONFIGURATIONS.
- INCORPORATES BERYLLIUM-COPPER CONTACTS INDIVIDUALLY SEALED USING CERAMAX® PROPRIETARY CERAMIC TO ESTABLISH A DURABLE HERMETIC SEAL.
- THE INTERNAL PINS CAN BE CONFIGURED TO ACCEPT INSULATED WIRE, AUTOMATIC WIRE BONDS, RIBBON WELDS, OR SOLDER CONNECTIONS.

1. LEAK RATE: LESS THAN OR EQUAL TO 1X10E-9 CC/SEC He AT ONE ATMOSPHERE DIFFERENTIAL PRESSURE.
2. INTERFACE AND MOUNTING HOLES IN ACCORDANCE WITH MIL-DTL-24308/2.
3. MATERIALS:
 CONTACT: BERYLLIUM-COPPER ALLOY 172/173 IN ACCORDANCE WITH ASTM B196/197.
 INSULATOR: CERAMAX PROPRIETARY CERAMIC.
 SHELL: STAINLESS STEEL 304L IN ACCORDANCE WITH SAE AMS-QQ-S-763.

4. FINISH:
 CONTACTS: NICKEL PLATE PER QQ-N-290, .000100/.000250 THICK.
 GOLD PLATE PER ASTM B488, TYPE III, CODE A, .000050/.000100 THICK.
 PLATE ENTIRE EXPOSED PIN, BOTH ENDS.
 SHELL: PASSIVATED

5. ORDERING INSTRUCTIONS:
 SPECIFY BASE NUMBER FOLLOWED BY DASH NUMBERS INDICATING PIN COUNT AND CONFIGURATION (SEE SHEET 2):

EXAMPLE: SRISD108 - 26 - A 1

- _____ DETAILED CONFIGURATION
- _____ PIN END STYLE (SEE VIEW A)
- _____ NUMBER OF CONTACTS, X (SEE SH3)
- _____ BASE NUMBER

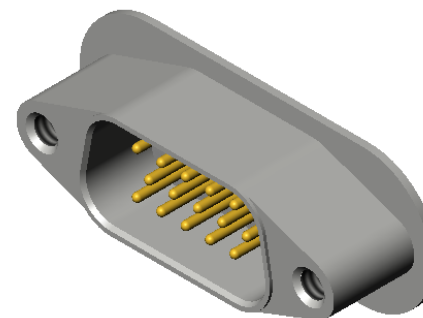

UNLESS OTHERWISE SPECIFIED
 DIMENSIONING IAW ASME Y14.5M-1994
 DIMENSIONS APPLY AFTER PROCESSES
 DIMENSIONS IAW US CUSTOMARY UNITS
 .X ± .1, .XX ± .01, .XXX ± .005, ∠ ± .5°
 .010 MAX OUTSIDE R, .005 MAX INSIDE R
 125 RMS SURFACE FINISH

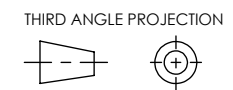

SRI HERMETICS (321) 254-4067
 WWW.SRIHERMETICS.COM

TITLE
 CONNECTOR, SUB-D, MID FLANGED, SC LBW

SIZE A	DOCUMENT SRISD108	REV A
SCALE 2:1	CAGE CODE 3PJY7	SHEET 1 OF 3

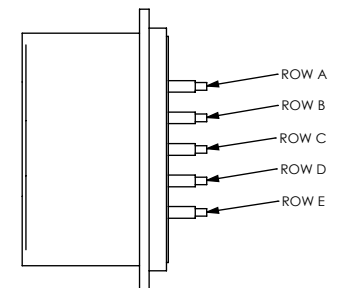
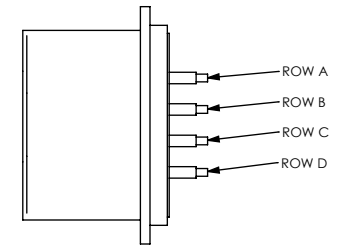
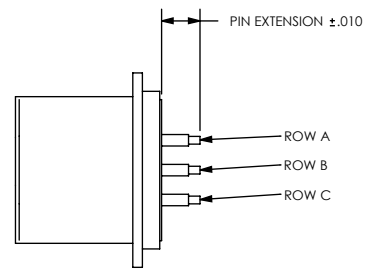
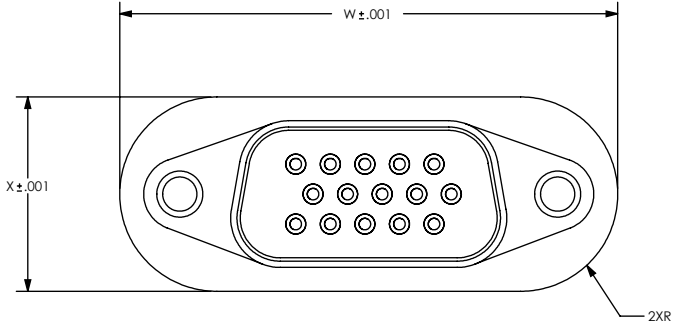

15, 26, 44, AND 62 PIN CONFIGURATIONS

78 PIN CONFIGURATION

104 PIN CONFIGURATION

PIN EXTENSIONS (SEE SH 3)

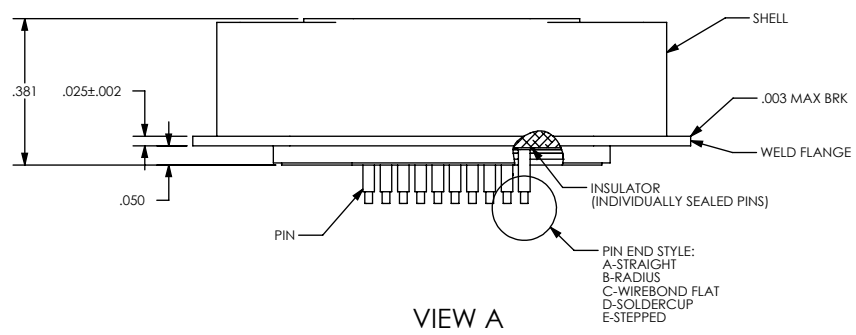

VIEW A

PIN END STYLE:
 A-STRAIGHT
 B-RADIUS
 C-WIREBOND FLAT
 D-SOLDERCUP
 E-STEPPED

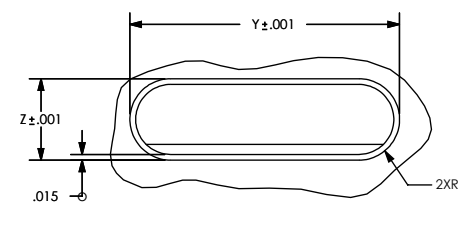

HOLE DETAIL

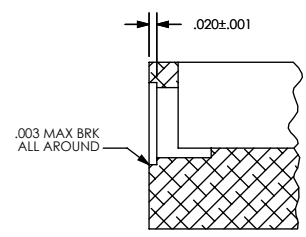

NUMBER OF CONTACTS	W	X	Y	Z
15	1.297	0.506	1.300	0.509
26	1.625	0.506	1.628	0.509
44	2.165	0.506	2.168	0.509
62	2.814	0.506	2.817	0.509
78	2.720	0.618	2.723	0.621
104	2.814	0.730	2.818	0.733

UNLESS OTHERWISE SPECIFIED
 DIMENSIONING IAW ASME Y14.5M-1994
 DIMENSIONS APPLY AFTER PROCESSES
 DIMENSIONS IAW US CUSTOMARY UNITS
 .X ±.1, .XX ±.01, .XXX ±.005, ∠ ±.5°
 .010 MAX OUTSIDE R, .005 MAX INSIDE R
 125 RMS SURFACE FINISH

THIRD ANGLE PROJECTION

SRI HERMETICS (321) 254-4067
 WWW.SRIHERMETICS.COM

TITLE: CONNECTOR, SUB-D, MID FLANGED, SC LBW

SIZE A	DOCUMENT SRISD108	REV A
SCALE 2:1	CAGE CODE 3PJY7	SHEET 2 OF 3

STRAIGHT PIN END STYLE, A

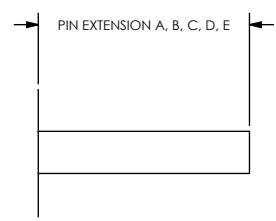

PART NUMBER	A	B	C	D	E
SRISD108 - X - A1	.345	.345	.345	.345	.345
SRISD108 - X - A2	.150	.150	.150	.150	.150

RADIUS PIN END STYLE, B

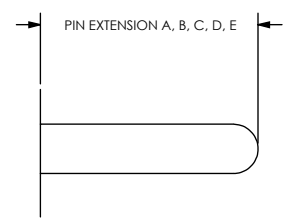

PART NUMBER	A	B	C	D	E
SRISD108 - X - B1	.360	.360	.360	.360	.360
SRISD108 - X - B2	.165	.165	.165	.165	.165

WIREBOND FLAT PIN END STYLE, C

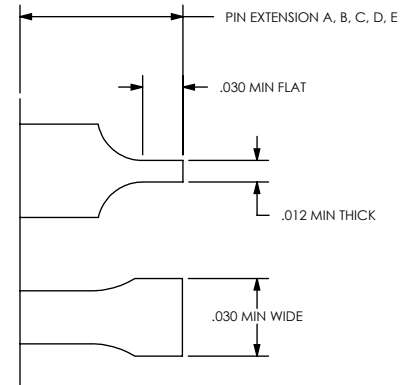

PART NUMBER	A	B	C	D	E
SRISD108 - X - C1	.360	.330	.300	.270	.240

SOLDERCUP PIN END STYLE, D

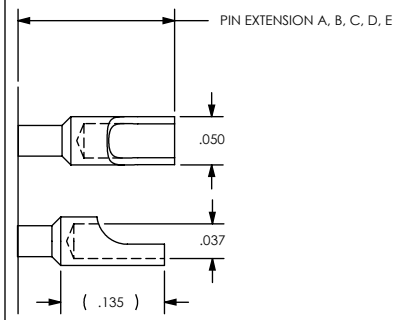

PART NUMBER	A	B	C	D	E
SRISD108 - X - D1	.185	.185	.185	.185	.185

STEPPED PIN END STYLE, E

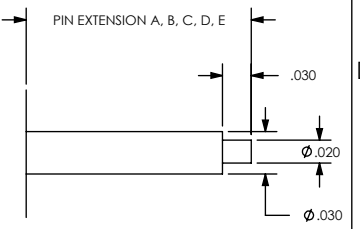

PART NUMBER	A	B	C	D	E
SRISD108 - X - E1	.100	.100	.100	.100	.100
SRISD108 - X - E2	.250	.250	.250	.250	.250

UNLESS OTHERWISE SPECIFIED
 DIMENSIONING IAW ASME Y14.5M-1994
 DIMENSIONS APPLY AFTER PROCESSES
 DIMENSIONS IAW US CUSTOMARY UNITS
 .X ± .1, .XX ± .01, .XXX ± .005, ∠ ± .5°
 .010 MAX OUTSIDE R, .005 MAX INSIDE R
 125 RMS SURFACE FINISH

THIRD ANGLE PROJECTION

SRI HERMETICS (321) 254-4067
 WWW.SRIHERMETICS.COM

TITLE: CONNECTOR, SUB-D, MID FLANGED, SC LBW

SIZE: A DOCUMENT SRISD108 REV: A

SCALE: 2:1 CAGE CODE 3PJY7 SHEET 3 OF 3